

MAIN FLOOR
1554 SQ. FT.
9' CEILING HEIGHT

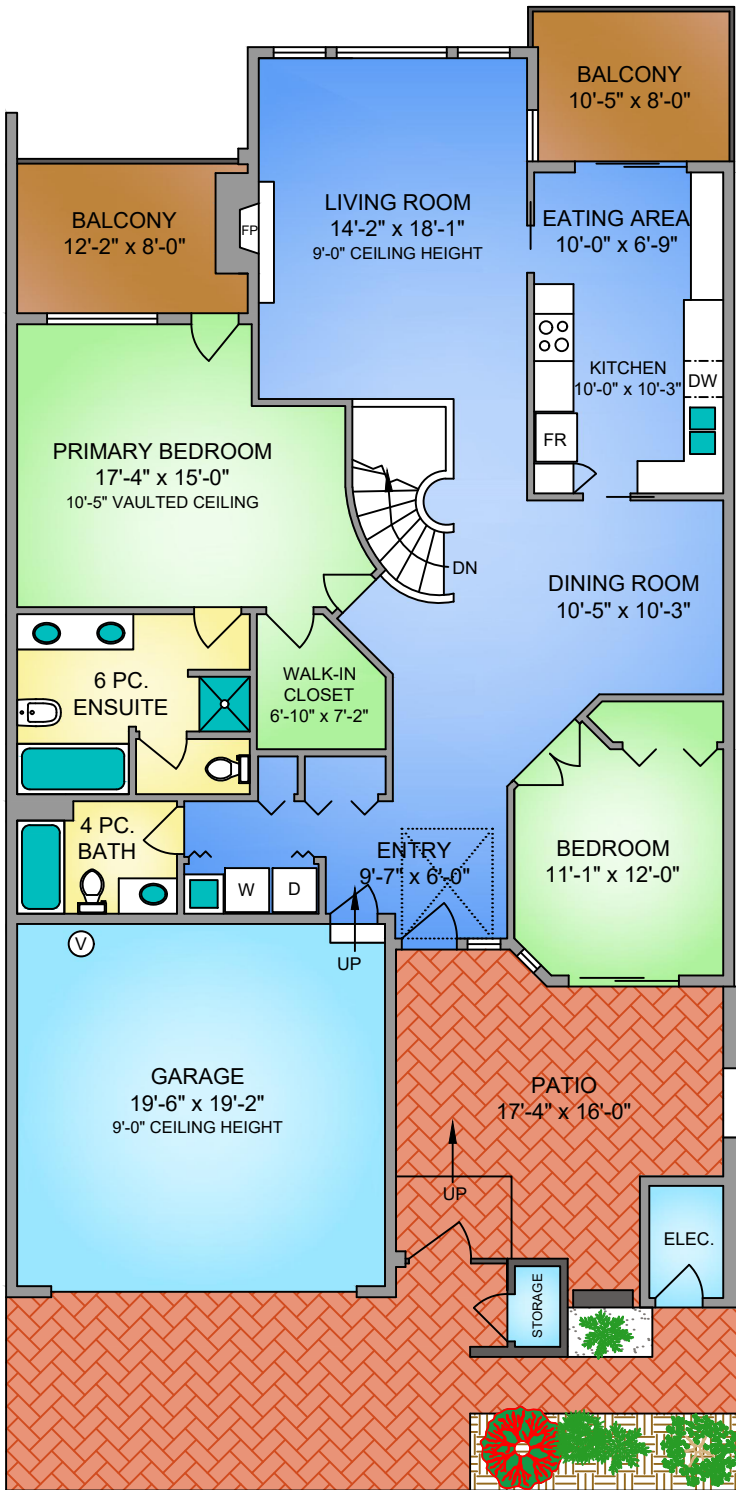

LOWER FLOOR
924 SQ. FT.
8' CEILING HEIGHT

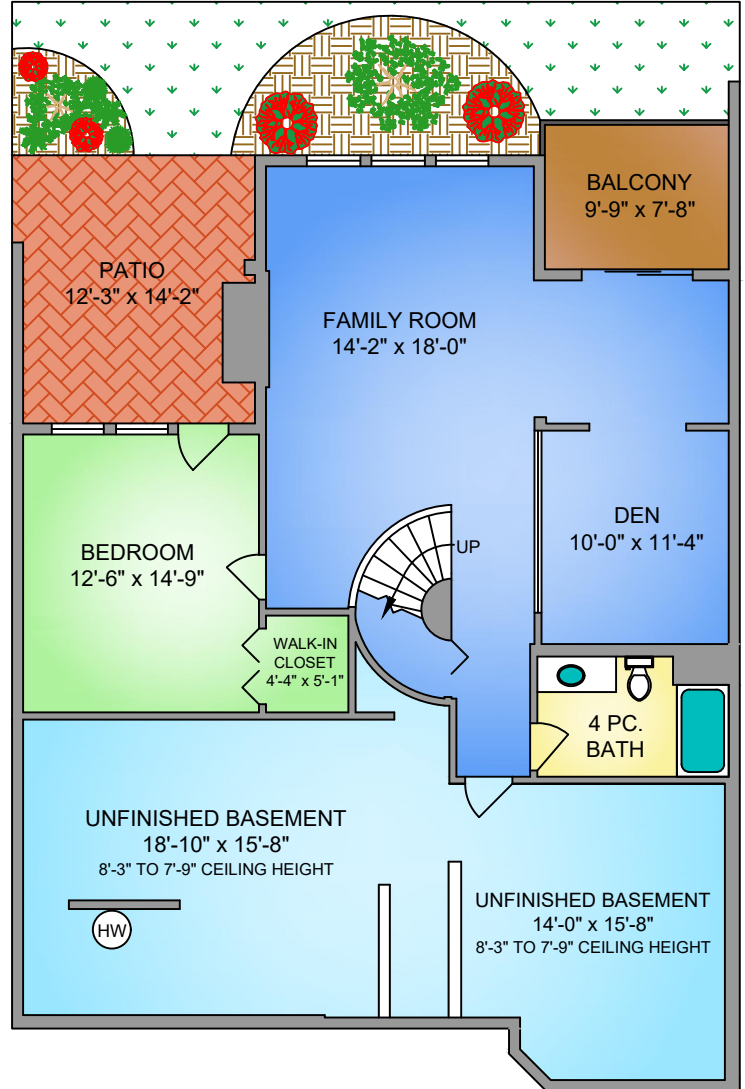

NORTH

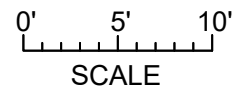
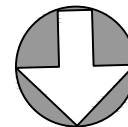

HB Homeward Bound
real estate team

ROYAL LEPAGE
Coast Capital Realty

PROPER MEASURE
PRECISION

250-884-9753
matt@propermeasure.com
www.propermeasure.com

UNIT 13 - 881 NICHOLSON STREET AUGUST 25, 2022				
PREPARED FOR THE EXCLUSIVE USE OF ROSIEMARIE COLTERMAN AND TOM OAK PLANS MAY NOT BE 100% ACCURATE, IF CRITICAL BUYER TO VERIFY.				
FLOOR	AREA (SQ. FT.)			
	FINISHED	UNFINISHED	GARAGE	BALCONY / PATIO
MAIN	1554	-	392	422
LOWER	924	607	-	242
TOTAL	2478	607	392	664